

# ADAPTER COUPLER SAF-8490

Adapter coupler (called also as “rescue coupler” or “half-coupler”), manufactured by FAE FANINA S.A. is used to make the connection between a vehicle equipped with the UIC draw-bar and a vehicle equipped with the automatic interconnector\* e.g. the type ZEa.

The low weight and the unique leveling solution make it convenient for a single trained operator to install and operate the device.

There is an option to order the coupler equipped with brake hoses (length 730 mm)

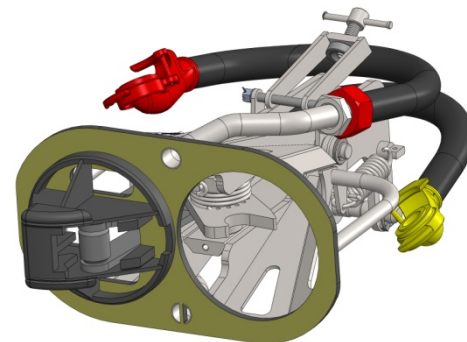
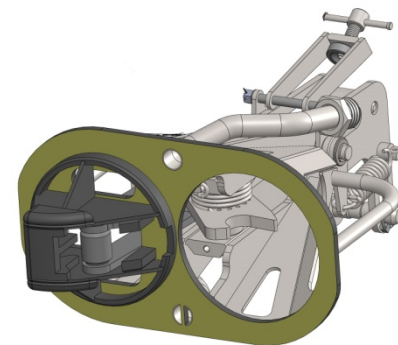

Technical data:

1.	The compression strength	- 250kN
2.	The endurance on the extension	- 400kN
3.	The distance of the axis of the hook to the frontal area	- 470 mm
4.	Weight of adapter coupler approx.	- 34.0kg
5.	The speed of uniting approx.	- 0,6km/h

The coupler is designed and manufactured in accordance with:

- EN 15020:2006+A1:2010 Railway applications - Rescue coupler – Performance requirements, specific interface geometry and test methods
- EN 15085-2 Railway applications - Welding of railway vehicles and components - Part 2: Requirements for welding manufacturer

*\*The difference between the height of the hook axis and the coupler axis from the rail head may not exceed the difference permitted by the regulations nor the quoted standards.*

FAE FANINA S.A. is certified by TDT (Polish Transport Technical Supervision), according standards PN-EN-ISO 3834 and PN-EN 15085 class CL-1 and have necessary powers to designing and manufacture railway welded constructions.

